



# BLDG 614

385 South Jade Street > TOOELE, UT

PETERSON INDUSTRIAL DEPOT LEASING OFFICE:  
545 N. Lodestone Way Tooele, UT 84074

WWW.PETERSONDEPOT.COM **435.849.8400**



## PROPERTY DETAILS

- 7,002 Total Building SF  
7,002 Office SF
- Construction: Wood Frame and Siding
- Roof: Asphalt Shingles
- Available Power:  
325 Amp/ 3 Phase/ 120-208 Volt
- Lot Size: .871 Acres
- Heating: Natural Gas, Forced Air
- Restrooms: Four



# BLDG 614

385 South Jade Street > TOOELE, UT

PETERSON INDUSTRIAL DEPOT LEASING OFFICE:  
545 N. Lodestone Way Tooele, UT 84074

WWW.PETERSONDEPOT.COM 435.849.8400

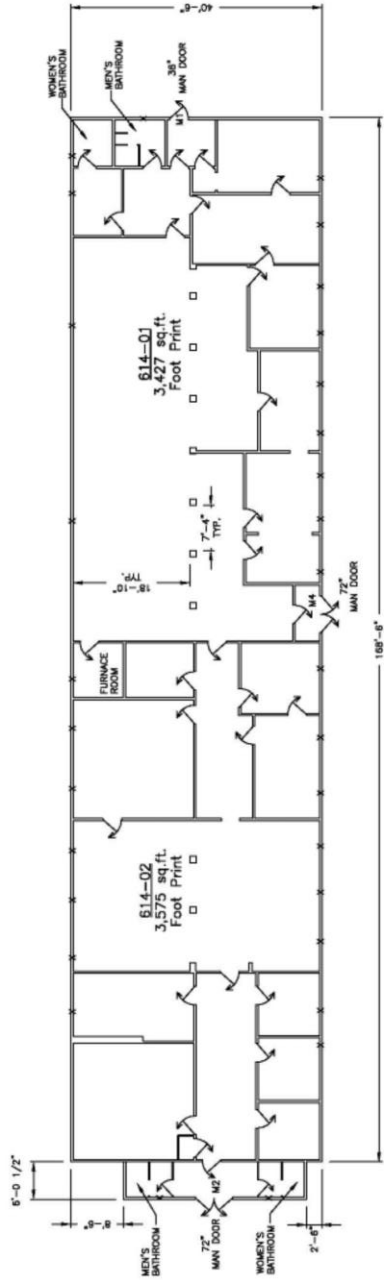

**LEGEND**  
X = WINDOWS

**NOTES:**  
ARROWS INDICATE DOOR SWING

