



BLDG 1503

1503 West Utah Ave. > TOOELE, UT

PETERSON INDUSTRIAL DEPOT LEASING OFFICE:
545 N. Lodestone Way Tooele, UT 84074

WWW.PETERSONDEPOT.COM 435.849.8400



PROPERTY DETAILS >

- 60,000 Total Building sq. ft.
- Construction: Concrete Tilt-Up
- Roof: TPO
- Clear Height: 30'
- Sprinklers: Wet Fire Suppression System
- Dock High Loading: Seventeen (17) 9' x 10' Roll Up
- Grade Level Loading: Six (6) 14' x 16' Roll Up
- Available Power: 277/480 Volt / 3 Phase
- Heating: Natural Gas





BLDG 1503

1503 West Utah Ave. > TOOELE, UT

PETERSON INDUSTRIAL DEPOT LEASING OFFICE:
545 N. Lodestone Way Tooele, UT 84074

WWW.PETERSONDEPOT.COM 435.849.8400

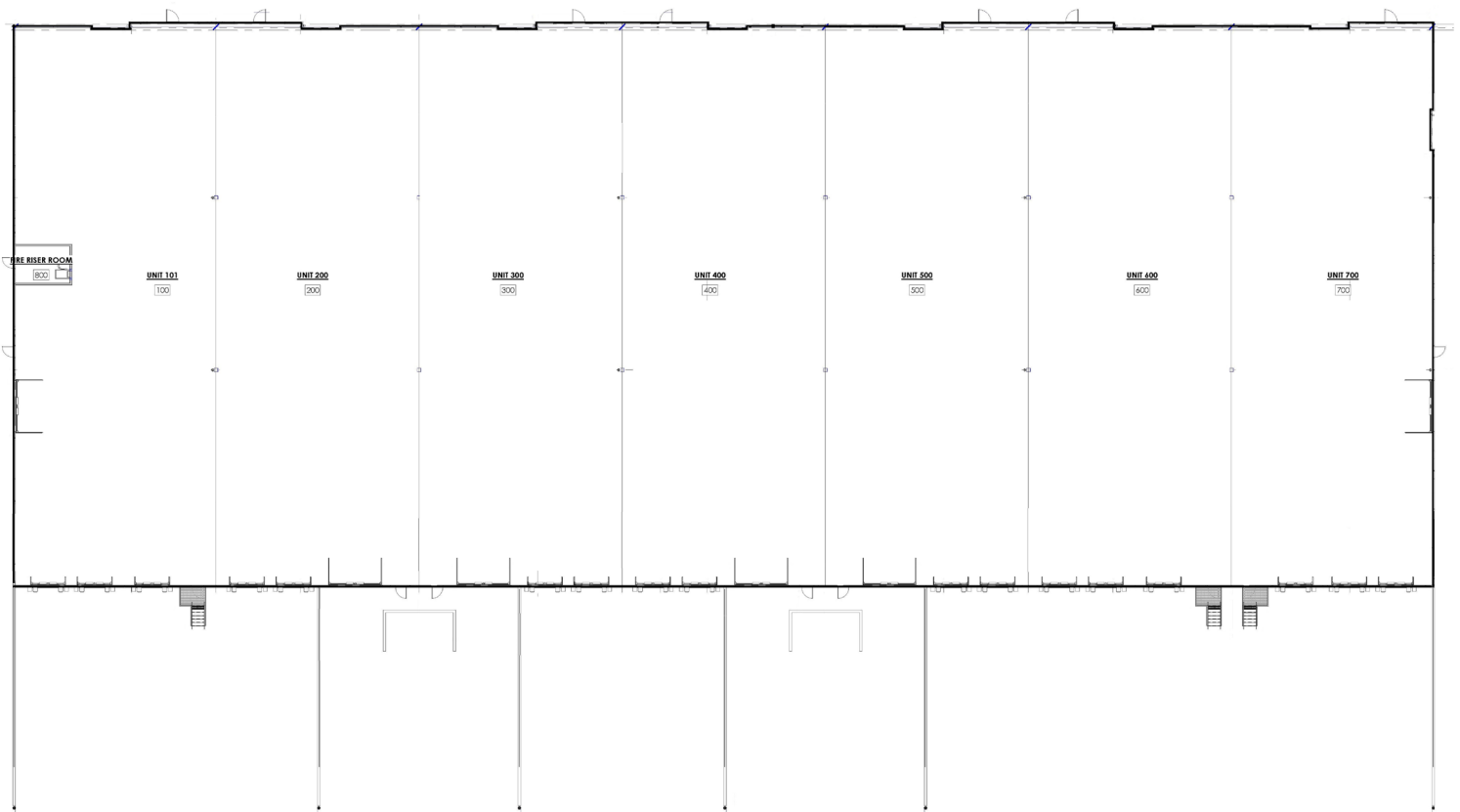

1 LEVEL 1
A101 1/16" = 1'-0"

0 8' 16' 32'
GRAPHIC SCALE



NORTH